

BASEMENT BEDROOM WINDOW

9.7.1.2. MINIMUM WINDOW AREAS

-bedroom window glass size must be 5% of the floor area of the bedroom (not including closet space)

9.7.1.3. BEDROOM WINDOWS

-unobstructed opening portion to be 3.8 sq.ft. with no dimension to be less than 15"
 -if there is a door providing DIRECT access to the exterior on the SAME floor level then the above statement does not apply (ie: main floor level, basement with walk out door, 2nd floor with balcony), however, the 5% requirement does still apply.
 -bedroom windows are to have a maximum sill height of 3'-3" from floor except for bedrooms in basements, where it is recommended (in the Appendix) to have access to the window improved some how (ie: built in furniture)

9.7.1.4. WINDOW OPENING INTO A WINDOW WELL

-clearance of 21 5/8" in front of window

9.15.4.2. FOUNDATION WALL & LATERAL SUPPORT

-openings larger than 3'-11" require lateral support

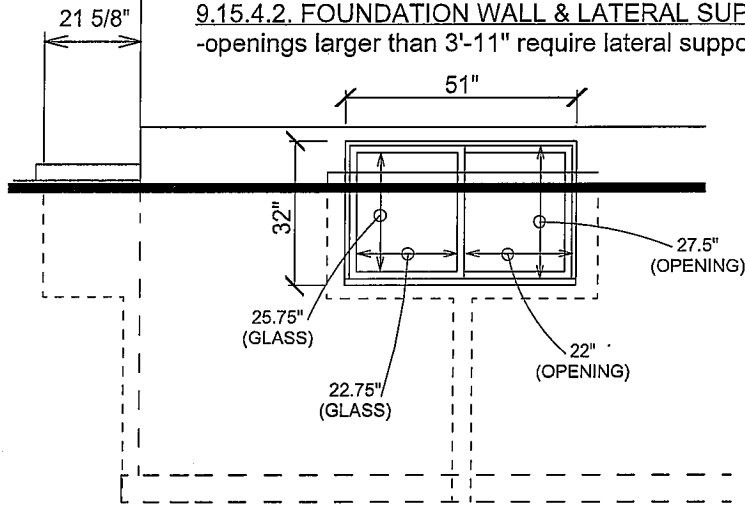

51X32 Pour In Place Slider

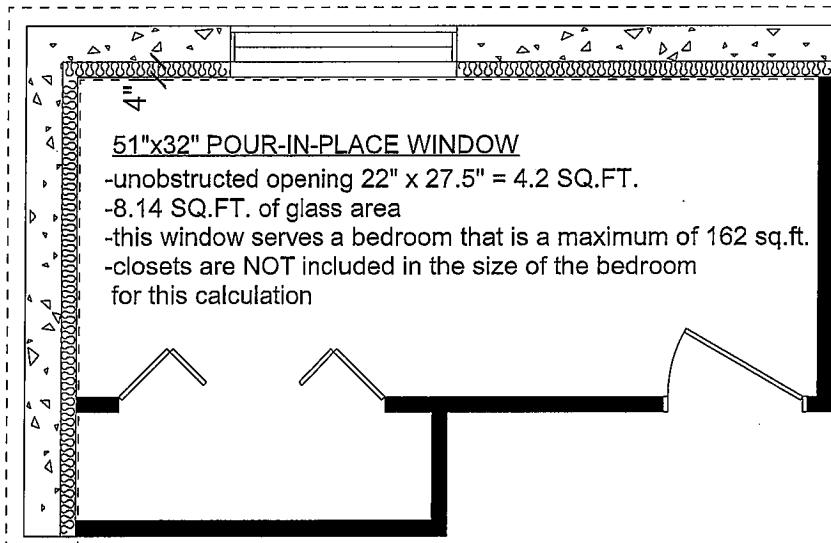

51"x32" POUR-IN-PLACE WINDOW

-unobstructed opening 22" x 27.5" = 4.2 SQ.FT.
 -8.14 SQ.FT. of glass area
 -this window serves a bedroom that is a maximum of 162 sq.ft.
 -closets are NOT included in the size of the bedroom for this calculation

CITY OF ST. THOMAS

Environmental Services Department
 Engineering Division
 Building Services

APPROVED PLANS

Date: NOV 12/08

Plans

Examiner: *[Signature]*

Permit #:

ST. THOMAS-ELGIN
 HOMEBUILDERS' ASSOCIATION
 TECHNICAL STANDARDS



SCALE: **N.T.S.**
 DATE: **NOVEMBER 10, 2008**
 REVIEWED BY C.B.O.

DETAIL: **BEDROOMS IN BASEMENTS**
 O.B.C. REFERENCE: **9.7.1.2, 9.7.1.3, 9.7.1.4**

DIAG #:
9.7.1.3
A-1